

DEORE XT Cassette Sprocket (10-Speed)

CS-M771-10 bj/bk/bL-Group

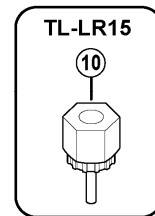
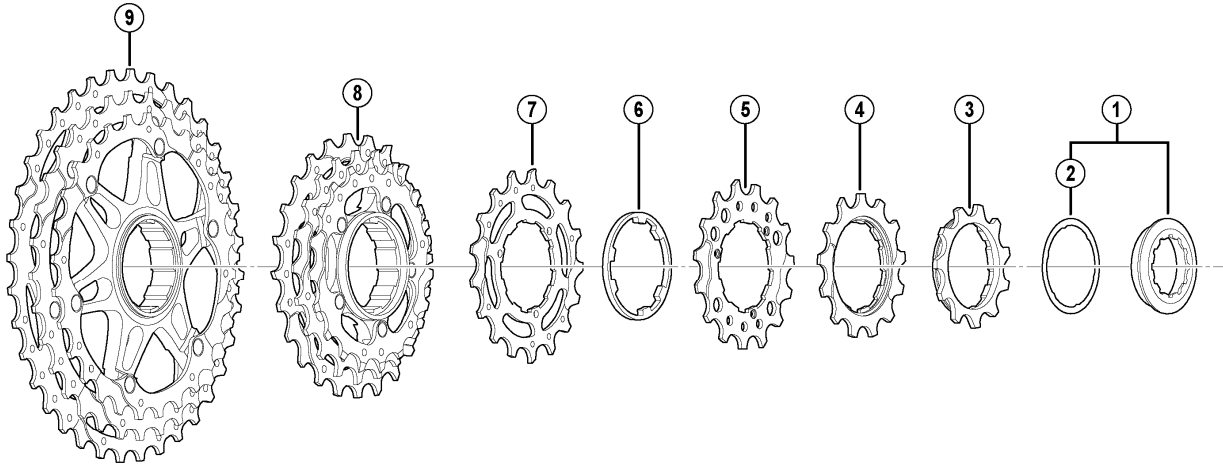

- bj-group sprocket teeth combination: 11-13-15-17-19-21-23-26-30-34T
- bk-group sprocket teeth combination: 11-13-15-17-19-21-24-28-32-36T
- bL-group sprocket teeth combination: 11-12-14-16-18-20-22-25-28-32T

	SHIMANO CODE NO.	DESCRIPTION	INTERCHANGEABILITY
1	Y1YR98010	Lock Ring & Spacer	
2	Y10Z04000	Lock Ring Spacer	
3	Y1YR11000	Sprocket Wheel 11T (Built in spacer type) for bj/bk-Group	
	Y1YR11100	Sprocket Wheel 11T (Built in spacer type) for bL-Group	
4	Y1YR13000	Sprocket Wheel 13T (Built in spacer type) for bj/bk-Group	
	Y1YR12000	Sprocket Wheel 12T (Built in spacer type) for bL-Group	
5	Y1YR15000	Sprocket Wheel 15T for bj/bk-Group	
	Y1YR14000	Sprocket Wheel 14T for bL-Group	
6	Y1Z805000	Sprocket Spacer (t=2.35 mm)	
7	Y1YR17000	Sprocket Wheel 17T for bj/bk-Group	
	Y1YR16000	Sprocket Wheel 16T for bL-Group	
8	Y1YR98020	Sprocket Unit (19-21-23T) for bj-Group (Cassette Sprocket Carrier for 5arm)	
	Y1YR98030	Sprocket Unit (19-21-24T) for bk-Group (Cassette Sprocket Carrier for 5arm)	
	Y1YR98040	Sprocket Unit (18-20-22T) for bL-Group (Cassette Sprocket Carrier for 4arm)	
9	Y1YR98050	Sprocket Unit (26-30-34T) for bj-Group (Cassette Sprocket Carrier for 6arm)	
	Y1YR98060	Sprocket Unit (28-32-36T) for bk-Group (Cassette Sprocket Carrier for 6arm)	
	Y1YR98070	Sprocket Unit (25-28-32T) for bL-Group (Cassette Sprocket Carrier for 5arm)	
10	Y12009230	Lock Ring Removal Tool (TL-LR15)	

A: Same parts.

B: Parts are usable, but differ in materials, appearance, finish, size, etc.

Absence of mark indicates non-interchangeability.

Apr.-2010-3017
© Shimano Inc. A