

# ULTEGRA Cassette Sprocket

## CS-6700 10-Speed

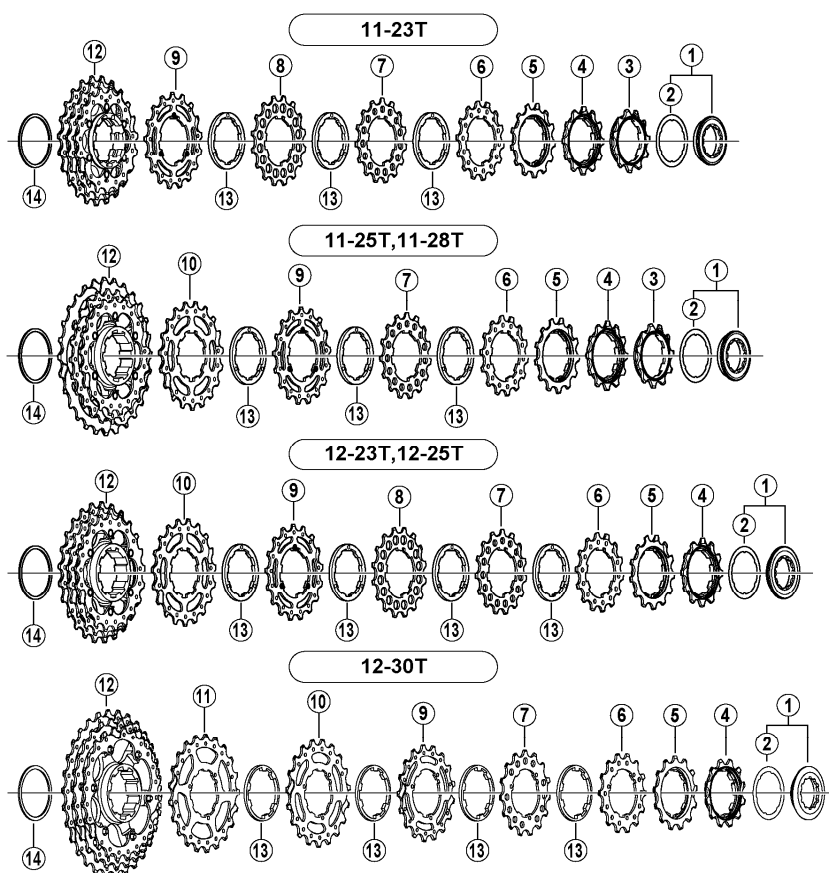

CS-6700 sprocket teeth combinations

11 - 23 T	11 - 12 - 13 - 14 - 15 - 16 - 17 - 19 - 21 - 23 T
11 - 25 T	11 - 12 - 13 - 14 - 15 - 17 - 19 - 21 - 23 - 25 T
11 - 28 T	11 - 12 - 13 - 14 - 15 - 17 - 19 - 21 - 24 - 28 T
12 - 23 T	12 - 13 - 14 - 15 - 16 - 17 - 18 - 19 - 21 - 23 T
12 - 25 T	12 - 13 - 14 - 15 - 16 - 17 - 19 - 21 - 23 - 25 T
12 - 30 T	12 - 13 - 14 - 15 - 17 - 19 - 21 - 24 - 27 - 30 T

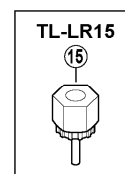

CS-7900

CS-6600

CS-5600

ITEM NO.	SHIMANO CODE NO.	DESCRIPTION	INTERCHANGEABILITY		
			CS-7900	CS-6600	CS-5600
1	Y1YX98010	Lock Ring & Spacer for 11T	B	B	B
	Y1YX98020	Lock Ring & Spacer for 12T	B	B	B
2	Y10Z04000	Lock Ring Spacer for 11T	A	A	A
	Y11W02000	Lock Ring Spacer for 12T	A	A	A
3	Y1Z81100D	Sprocket Wheel 11T (Built in spacer type)	A	A	B
4	Y1Z81200D	Sprocket Wheel 12T (Built in spacer type)	A	A	B
5	Y1Z81300D	Sprocket Wheel 13T (Built in spacer type) for 11-23T, 11-25T, 11-28T, 12-23T, 12-25T	A	A	B
	Y1ZD1390D	Sprocket Wheel 13T (Built in spacer type) for 12-30T			A
6	Y1Z81400D	Sprocket Wheel 14T	B	A	B
7	Y1Z81500D	Sprocket Wheel 15T	B	A	B
8	Y1Z81600D	Sprocket Wheel 16T	B	A	B
9	Y1ZD1700E	Sprocket Wheel 17T for 11-23T, 12-23T, 12-25T			
	Y1YX1700D	Sprocket Wheel 17T for 11-25T, 11-28T, 12-30T			
10	Y1ZD1800E	Sprocket Wheel 18T for 12-23T		A	
	Y1YX1900D	Sprocket Wheel 19T for 11-25T, 11-28T, 12-30T			B
	Y1ZD1900E	Sprocket Wheel 19T for 12-25T		A	B
* 11	Y1YF21100	Sprocket Wheel 21T			
	Y1YX98030	Sprocket Unit (19-21-23T) for 11-23T		B	B
12	Y1YX98040	Sprocket Unit (19-21-23T) for 12-23T	B	B	
	Y1YX98050	Sprocket Unit (21-23-25T) for 11-25T, 12-25T			
	Y1YX98060	Sprocket Unit (21-24-28T) for 11-28T	B		
	Y1YX98070	Sprocket Unit (24-27-30T) for 12-30T			
13	Y1Z805000	Sprocket Spacer (t=2.35 mm)	B	A	B
14	Y1Z807000	Low Spacer (t=1.0 mm)	A	A	A
15	Y12009230	Lock Ring Removal Tool (TL-LR15)	A	A	A

A: Same parts.

B: Parts are usable, but differ in materials, appearance, finish, size, etc.

Absence of mark indicates non-interchangeability.

Apr.-2012-2924B

© Shimano Inc. A

Specifications are subject to change without notice.

# SHIMANO